

All:

Please see attachments regarding the proposed consolidation plans for the South Fayette Township Municipal Complex.

The sanitary sewer locations depicted on the proposed consolidation plan are incorrect.

They do not reflect the changes made as shown on the CEC drawings 300880.... attached.

I have also attached other information in this regard including wye locations for the revised sewer.

Note that the sanitary sewer now terminates at CEC manhole No. 105.

We have not received as-built information for the revised sanitary sewer but the referenced drawings from CEC were used for construction.

Ultimately, as-built information in this regard should be provided to MATSF.

Please accept this email as my initial comments regarding the consolidation plan.

Let me know if you have any questions in this regard.

Thanks,

Jerry

Jerry D. Brown

Managing Director

Municipal Authority of the Township of South Fayette

900 Presto Sygan Road

Bridgeville, PA 15017

412-257-5100 Ext 5 Office

412-257-5125 Fax

412-287-0721 Mobile



March 30, 2021

Mr. John M. Barrett
Township Manager
South Fayette Township
515 Millers Run Road
South Fayette, PA 15064

Dear Mr. Barrett:

Subject: Contract MC-01-21 – Change Order No. 1
South Fayette Municipal Complex
South Fayette Township, Allegheny County, Pennsylvania
CEC Project 300-880

Civil & Environmental Consultants, Inc. (CEC) presents for your consideration the following summary and attachments constituting Change Order No. 1 for the subject project. Our preparation of this change order was based on suggestions made by Alex Paris during our pre-construction meeting on March 10, 2021, and as you and I discussed on our phone call last week.

Change Order No. 1 includes the installation of an additional 140 LF of 6" sanitary sewer, including its connection to proposed Manhole 101. This work was originally intended to be completed during Phase 2 with the building construction. However, an overall cost savings can be achieved if it is installed prior to the placement of Phase 1 fill, thereby eliminating the need to cut a deep trench during Phase 2 and consequently saving on the installation cost. Attached plans sheets C100, C500, C501 and C900 have been revised to show the additional 140 LF of 6" sanitary sewer.

The change order amount is \$5,096.00. This amount is based on an additional 113 LF of 6" Sanitary Sewer (PVC) not under pavement, at the contract unit price bid of \$31.00/LF (original Line Item 19), and an additional 27 LF of 6" Sanitary Sewer (PVC) under pavement, at the contract unit price bid of \$59.00/LF (original Line Item 20). These additional items would be added to the contract as Line Items 1.1 and 1.2, as shown on the attached Pay Application markup.

There is no change proposed to the contract timeline.

Please review and respond with any questions you may have. If acceptable, please return your authorization. Upon receipt, CEC will notify Alex Paris of the change and forward a copy of this correspondence to them along with your authorization.

Very truly yours,

CIVIL & ENVIRONMENTAL CONSULTANTS, INC.

Christopherjohn M. Dombroskie, P.E., CPESC
Project Manager

Eduardo J. Intriago, P.E.
Principal

Enclosure

300-880-L-PH1CO1-3.30.21

OWNER'S ADOPTION AND DEDICATION

By a resolution approved on the _____ day of _____, 20____, the Board of Directors of the Township of South Fayette adopted this plan as a final consolidation plan and hereby dedicated all streets and other property identified for dedication on this plan to the Township of South Fayette. This adoption and dedication shall be binding upon the corporation and upon its successors and assigns. (Seal)

Name of Corporation _____

Signature and Title of Officer _____

Signature and Title of Authorized Officer Witnessing _____

Date _____

ACKNOWLEDGMENT OF NOTARY PUBLIC

I, the undersigned Notary Public in and for the Commonwealth of Pennsylvania and County of Allegheny, personally appeared _____ of the Township of South Fayette, who stated that (he/she) is authorized to execute the above adoption and dedication on behalf of the corporation and was present at the meeting at which the action of the corporation was taken to adopt the plan and dedicate public property contained therein to the Township of South Fayette. Witness my hand and notarial seal this _____ day of _____, 20____.

My commission expires the _____ day of _____, 20____.

(Seal) _____

CERTIFICATION OF TITLE

We have carefully examined the title to the property contained in the foregoing plan and certify that the same is in accordance with the Township of South Fayette and that the same is in accordance with the standards required by the Township of South Fayette.

SURVEYOR'S CERTIFICATION

I certify that to the best of my information, knowledge and belief the survey and plan shown here on are correct and accurate to the standards required by the Township of South Fayette.

Date _____

(Seal) _____

MUNICIPAL DECLARATIONS

Received by the Planning Commission of the Township of South Fayette this _____ day of _____, 20____.

Secretary _____

(Seal) _____

Received by the Allegheny County Department of Economic Development on this _____ day of _____, 20____.

(Seal) _____

ALL SIGNATURES ON THIS PLAN ARE TO BE MADE IN PERMANENT BLUE INK ONLY.

SURVEYOR (EMPOWERED)

SURVEYOR (SEAL)

TOWNSHIP BUSINESS

TOWNSHIP OF SOUTH FAYETTE

ALLEGHENY COUNTY

DEPARTMENT OF REAL ESTATE

NOTES

- This plan proposes the consolidation of 2 separate parcels into one whole. The parcels 323-1-100 and 323-1-110 (A, K, A, Lot 1 & Lot 2 of PB V 288, PG 92, hereinafter "Project Area") are to be consolidated into one parcel, as shown on this plan.
- The proposed plan hereon is subject to all applicable zoning ordinances, restrictions & survey areas which appear on the instruments, which form the record chain of title, or which are visible on the premises.
- Existing meter locations shown on plan shall be extended by the recording of this plan.
- North Bearing 95 stems is based on previous survey recorded in the Recorder's Office of Allegheny County, PB 288, PG 92.
- Existing features graphics on this plan are drawn in accordance with plans created by Civil & Environmental consultants for use in development and construction of Existing 40'.



DATE	PERSON	SCALE
07-29-2022	RP-1	I = 80'
15762	RP-1	

MUNICIPAL COMPLEX CONSOLIDATION PLAN

SITUATED IN SOUTH FAYETTE TOWNSHIP, ALLEGHENY COUNTY, PA

OWNER/DEVELOPER: GIBSON, THOMAS ENGINEERING CO

9815 OLD FERRY HIGHWAY, SOUTH FAYETTE, PA 15664



Municipal Authority of the Township of South Fayette
900 Presto-Sygan Rd. Bridgeville PA
412-257-5100

WYE DRAWING

PLAN VIEW

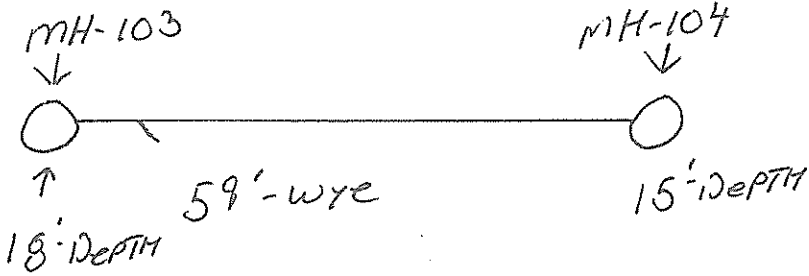

GENERAL INFORMATION

DEVELOPMENT _____
CONTRACT NUMBER _____
MAIN CONTRACTOR PARIS

LOT# _____
PROPERTY OWNER SOUTH-FAYETTE TWP
PROPERTY ADDRESS 337- HICKORY GRADE ROAD

SURVEY STATION 0 + 59
SIZE STUB 6" DATE INSTALLED 6-7-21
RECORDED BY _____
NUMBER OF BENDS USED 1
L.F. 6-INCH STUB 14'
DEPTH AT INVERT _____ DEPTH AT END _____

DATE SERVICE LATERAL INSTALLED Existing
INSPECTED BY _____
TOTAL LENGTH _____
PLUMBER _____

MH-103 8' wye-59' DETAILED VIEW MH-104 14'-STUB

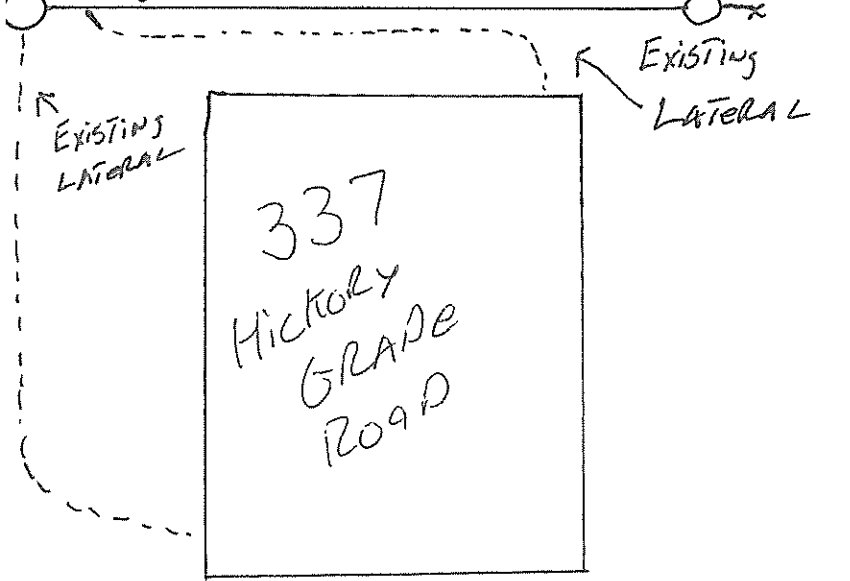

MISCELLANEOUS

SEE CONTRACT DRAWING NUMBER _____

Municipal Authority of the Township of South Fayette
900 Presto-Sygan Rd. Bridgeville PA
412-257-5100

WYE DRAWING

PLAN VIEW

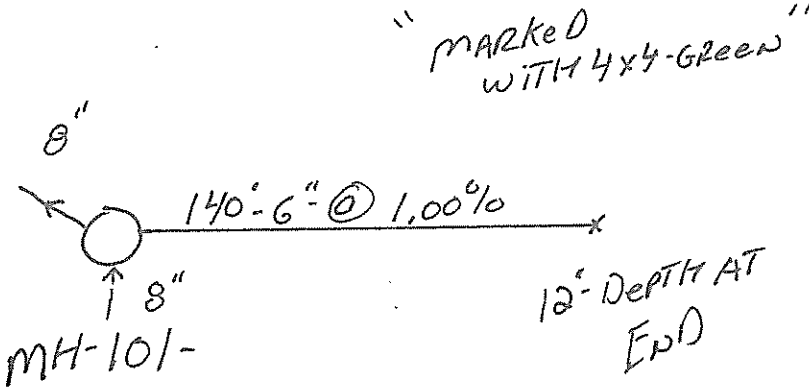

GENERAL INFORMATION

DEVELOPMENT _____
CONTRACT NUMBER _____
MAIN CONTRACTOR PARIS

LOT# FUTURE TWP. 3105 323- HICKORY
PROPERTY OWNER SOUTH-FAYETTE TWP
PROPERTY ADDRESS _____

SURVEY STATION 0 + 00
SIZE STUB 6" DATE INSTALLED 6-10-21
RECORDED BY BC
NUMBER OF BENDS USED 0
L.F. 6-INCH STUB 140'
DEPTH AT INVERT 20' DEPTH AT END 12'

DATE SERVICE LATERAL INSTALLED _____
INSPECTED BY _____
TOTAL LENGTH _____
PLUMBER _____

DETAILED VIEW

MISCELLANEOUS

SEE CONTRACT DRAWING NUMBER